

ROTEX® GS Clamping ring hubs light Backlash-free jaw couplings

Integrated clamping system made of aluminium

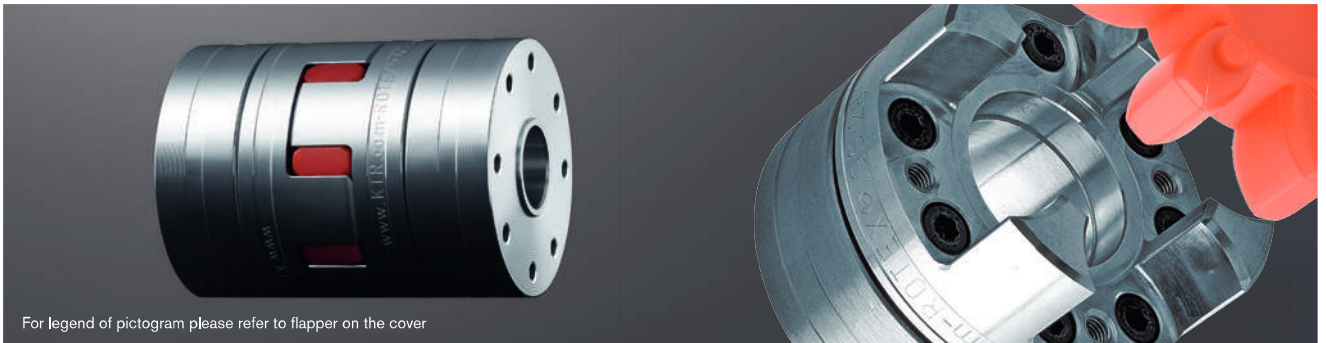

For legend of pictogram please refer to flapper on the cover



Tack thread M₁ between clamping screws

Clamping ring hub light with block mounting (hub and clamping ring mounted as a block)

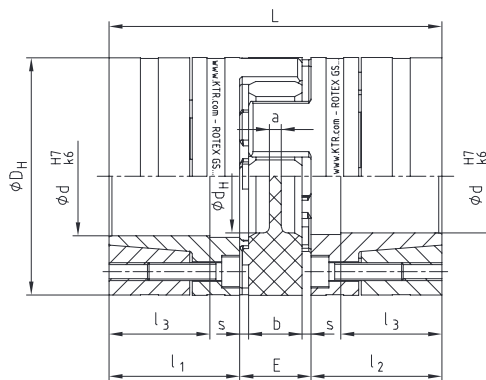

ROTEX® GS clamping ring hubs light

Size	Spider GS ¹⁾ torque T _{KN} [Nm]			Dimensions [mm]										Clamping screws DIN EN ISO 4762			Weight per hub with max. bore [kg]	Mass moment of inertia per hub with max. bore [kgm ²]	
	92 ShA	98 ShA	64 ShD	d _{max.}	D _H ²⁾	d _H	L	l ₁ , l ₂	l ₃	E	b	s	a	M	z = number	T _A [Nm]			M ₁
14	7.5	12.5	16.0	14	30	10.5	50	18.5	13.5	13	10	1.5	2.0	M3	4	1.34	M3	0.032	0.04 x 10 ⁻⁴
19	12	21	26	20	40	18	66	25	18	16	12	2.0	3.0	M4	6	3	M4	0.077	0.19 x 10 ⁻⁴
24	35	60	75	32	55	27	78	30	22	18	14	2.0	3.0	M5	4	6	M5	0.162	0.78 x 10 ⁻⁴
28	95	160	200	38	65	30	90	35	27	20	15	2.5	4.0	M5	8	6	M5	0.240	1.70 x 10 ⁻⁴
38	190	325	405	48	80	38	114	45	35	24	18	3.0	4.0	M6	8	10	M6	0.490	5.17 x 10 ⁻⁴
42	265	450	560	51	95	46	126	50	35	26	20	3.0	4.0	M8	4	25	M8	0.772	11.17 x 10 ⁻⁴
48	310	525	655	55	105	51	140	56	41	28	21	3.5	4.0	M10	4	49	M10	1.066	18.81 x 10 ⁻⁴

¹⁾ For selections see page 22 et seqq/other spiders see page 123 and following

²⁾ ØD_H + 2 mm with high speeds for expansion of spider

Review of shaft-hub-connection: Friction torques T_R [Nm] for hub design 6.0 light

Size		Ø6	Ø8	Ø9	Ø10	Ø11	Ø14	Ø15	Ø16	Ø19	Ø20	Ø24	Ø25	Ø28	Ø30	Ø32	Ø35	Ø38	Ø40	Ø42	Ø45	Ø48	Ø50	Ø55*	
14	H7/k6	8.2	13.1	18.7	20.5	25.9	36.2																		
	H7/h6	5.8	9.5	15.7	16.6	21.6	24.7																		
19	H7/k6				33	41	59	71	51	80	92														
	H7/h6				27	35	52	65	39	68	81														
24	H7/k6						84	99	93	139	157	160	177	232											
	H7/h6						75	92	79	125	145	119	136	190											
28	H7/k6								140	207	188	289	316	355	414	324	404	422							
	H7/h6								121	187	157	263	293	318	381	245	324	343							
38	H7/k6										290	439	480	567	656	617	759	733	825	922	808	937			
	H7/h6										247	403	447	530	626	499	636	606	696	792	678	809			
42	H7/k6														651	752	747	916	1001	1115	1044	1218	1404	1432	
	H7/h6														574	681	613	774	881	1001	888	1058	1241	1295	
48	H7/k6														765	822	927	1121	1220	1357	1318	1536	1768	1535	1834
	H7/h6														678	760	837	1047	1085	1231	1128	1339	1566	1331	1591

* Standard bore tolerance H7, special tolerances on request * From Ø55 tolerance G7/m6

The torque is reduced with bigger fitting tolerances. Steel or nodular iron with a yield strength of approx. 250 N/mm² or more can be used as shaft material. For strength calculation of shaft/hollow shaft see KTR standard 45510 on our homepage www.ktr.com.

Ordering example:	ROTEX® GS 24	98 ShA-GS	d 20	6.0 light - Ø24		6.0 light - Ø20	
	Coupling size	Spider hardness	Optional: Bore in spider	Hub design	Finish bore	Hub design	Finish bore